

## INSTALLATION INSTRUCTIONS



**FloorLyft Underlayment** is designed for use with all Vinyl Planks and Tiles, Laminate, and floating and glue down wood, cork, bamboo, residential and commercial carpet, and carpet tile. This sound reduction underlay system is easy to install and is suitable for use over most types of industry approved sub floors (3/4" Plywood, concrete, OSB flooring, etc.)

### General Information:

#### • Wood Sub Floors:

Using a species-specific moisture meter, determine if conditions are dry before installing. Wood sub floor moisture reading must not exceed 12%. If moisture readings are too high, postpone the installation and resolve the issue.

#### • Concrete Sub Floors:

Concrete must be at least 60 days old. Emission rate of concrete is not to exceed 5lbs/1000sf/24hrs per calcium chloride test. If emission rate exceeds that amount, a vapor barrier is to be paired with FloorLyft. Vapor Barriers include, but are not limited to 6mil Polyethylene film, vapor retarding adhesive, or QW Prime Seal.

#### • Floor Preparation:

All wood and concrete subfloors must be flat within 1/8" over a 6' span, or 3/16" over a 10' span. All seams of FloorLyft must meet this requirement as well. Be sure the subfloor is clean, smooth, and free of dust and debris. All areas must be checked prior to installation.

**Note:** Due to the nature of our manufacturing process and the use of recycled material, the pad thickness may vary .5mm plus/minus. The size may also vary by 1%. While the appearance of the panels may change, we guarantee this slight variance DOES NOT affect functionality of the product.

#### • Application Specifics:

- If installing a floating floor covering 4mm or greater in overall thickness, FloorLyft can be floated, glued, or stapled.
- If installing a floating floor covering less than 4mm in overall thickness, FloorLyft must be glued to the substrate and the overlying floor covering can be floated.
- If installing a glue down floor covering of any thickness, FloorLyft must be glued to the substrate.

#### Tools Needed (pic #1):

- Utility blade (keep blades fresh/new)
- Straight edge
- Marker
- Tape Measure

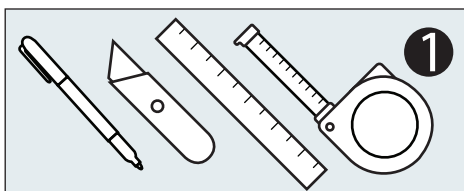

### Installation:

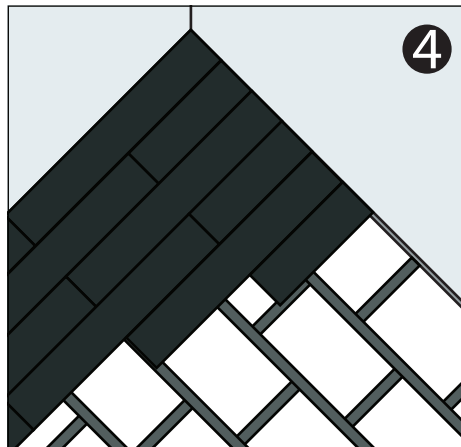
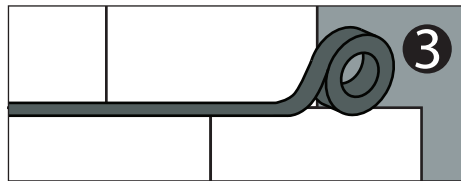
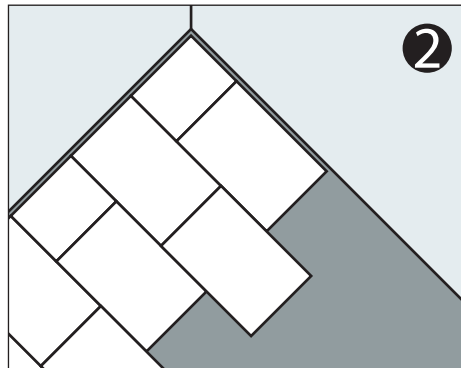

#### Floating Installation:

- FloorLyft can only be floated when paired with a 4mm or thicker floating floor covering.
- Begin laying panels of FloorLyft perpendicular to flooring direction, butting them tightly (**see pic #2**).
- Panels need to be staggered at approximately 50%, eliminating a grid style layout (**see pic #2**).
- 1/4" Expansion gap is to be left at all perimeter walls (**see pic #2**).
- Seams must be taped using a good quality duct tape, minimum 2 inches wide (**see pic #3**).

- Install flooring perpendicular to FloorLyft according to flooring manufacturer's specifications (**see pic #4**).

#### Mechanically Fastened Down Installation:

- Begin laying panels of FloorLyft perpendicular to flooring direction, butting them tightly (**see pic #2**).
- Fasteners need to be placed a minimum of every 6 inches with perimeter fasteners no more than 2 inches from the edge of each panel.
- Panels need to be staggered at approximately 50%, eliminating a grid style layout (**see pic #2**).
- 1/4" Expansion gap is to be left at all perimeter walls (**see pic #2**).
- All seams need to be properly prepared in accordance with the flooring manufacturer's recommendations when installing any flooring 3mm or thinner.
- Taping of seams can be done but is not necessary in staple down applications (**see pic #3**).
- Fasteners must be long enough to penetrate through the FloorLyft panels and the existing subfloor entirely.
- Install flooring perpendicular to FloorLyft according to manufacturer's specifications (**see pic #4**).

#### Glue Down Installation:

(Required for planks less than 4mm thick)

- FloorLyft is to be glued down when paired with any glue down floor covering or a floating floor covering <4mm thick.
- Begin by troweling a good quality pressure sensitive adhesive using the recommended trowel size from the adhesive manufacturer.
- Lay panels of FloorLyft perpendicular to flooring direction, butting them tightly (**see pic #2**).
- FloorLyft panels are to be installed while adhesive is still wet.
- FloorLyft panels need to be rolled with a 75lb-100lb roller to ensure a full bond is made.
- Panels need to be staggered at approximately 50% eliminating a grid style layout (**see pic #2**).
- 1/4" Expansion gap is to be left at all perimeter walls (**see pic #2**).
- All seams need to be properly prepared in accordance with the flooring manufacturer's recommendations. Failure to properly prepare seams will void all warranty.
- We do not recommend taping seams in glue down installation.
- Install flooring perpendicular to FloorLyft according to manufacturer's specifications (**see pic #4**).